

Hallenplan

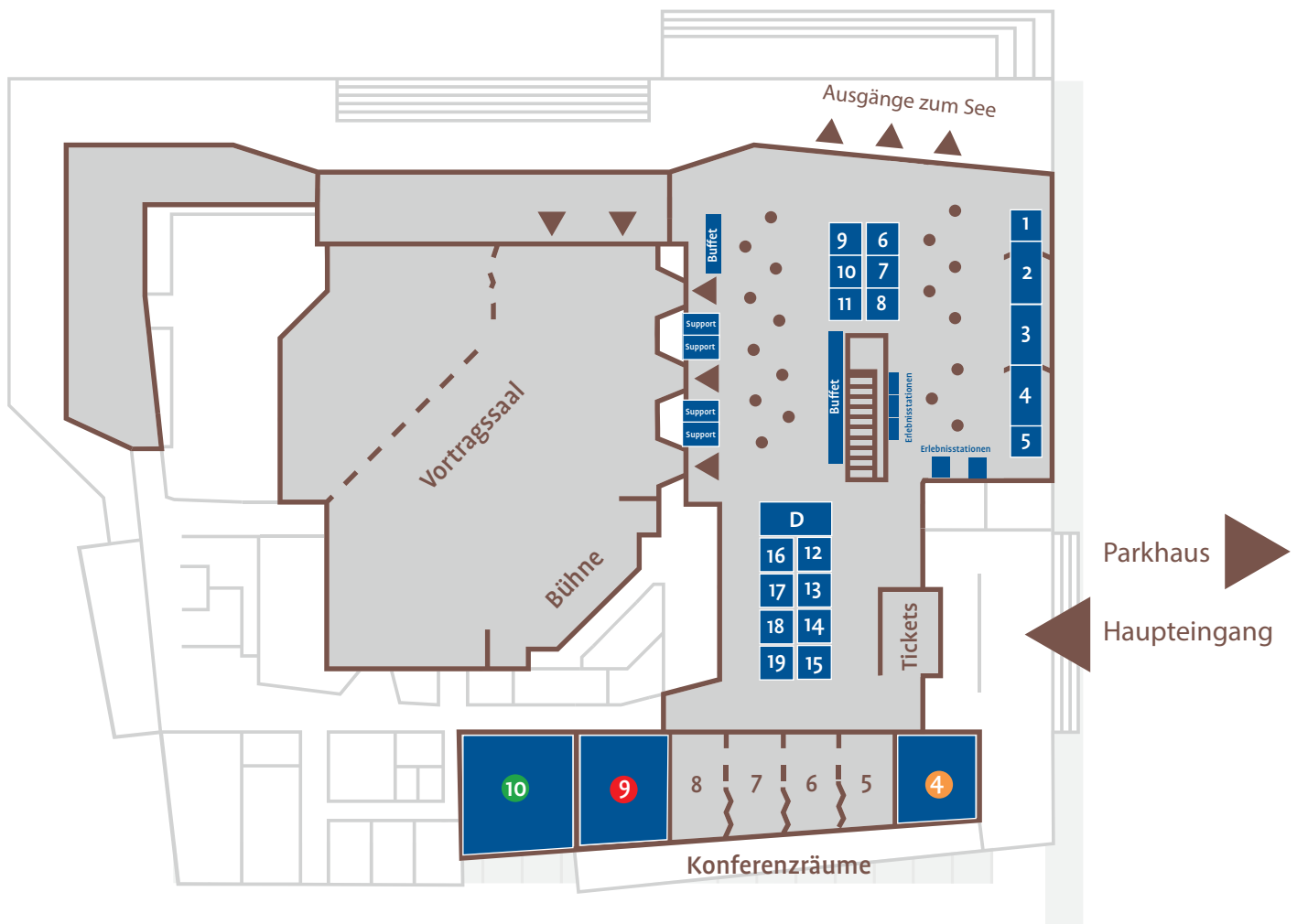

Partnerausstellung

- | | | |
|----------------------|-----------------------|--------------------|
| 1. BETA CAE Systems | 8. Kreon Technologies | 15. MetrologyWorks |
| 2. Hexagon Metrology | 9. API | 16. sigma3d |
| 3. Creaform - AMETEK | 10. Eleven Dynamics | 17. Messkonzept |
| 4. FARO | 11. SHINING 3D | 18. AESUB |
| 5. RENISHAW | 12. SCANTECH | 19. ATTBLIME |
| 6. dk Fixiersysteme | 13. Matrix | |
| 7. 3D INFOTECH | 14. Witte Barskamp | D. Duwe-3d |

Konferenzräume für Mini-Workshops

